

TOP regional Must-Sees and Experiences for groups



Visit Estonia & Destination Management Organizations
April 2026

Tallinn, the capital city

Tales of Reval

- + Location: Tallinn
- + Website: [Tales of Reval immersion tour | Visit Estonia](#)
- + Contact: Cedric Stimmlich. +372 5560 4421, info@talesofreval.ee
- + Main service: Guiding services in the Old Town
- + Group size: 1 - 120pax
- + Duration: 30 - 150 min
- + Languages: English, German, Estonian
- + Price: 45€ per person, 450€ minimum. For bigger groups than 30 people, the price is negotiable.
- + Additional services: DMC services, adventure games and Live-Action Role Plays. Event hosting and ceremony masters.



Food Studio cooking class

- + Location: Tallinn
- + Website: [Food Studio, cooking workshops | Visit Estonia](#)
- + Contact: info@foodstudio.com, ph. (+372) 655 6300
- + Main service: Cooking classes
- + Group size: 12-54
- + Duration: usually 4 hours
- + Languages: Estonian, English, Russian
- + Price: Depends on the group and activity. Min price usually around 1000€+VAT
- + Additional services: Cocktail classes, Wine tasting, Blind tasting, Seminars etc.



Stella Soomlais leather workshop

- + Location: Tallinn
- + Website: [Stella Soomlais studio](#) | [Visit Estonia](#)
- + Contact: design@stellasoomlais.com or call to the studio +372 56 997 214
- + Main service: leather workshops
- + Leather accessory workshop format is excellent for a team building event. In addition to having fun in a creative environment new knowledge and practical skills are guaranteed. A cherry on top of it – the workshop is tailored so that even people with no previous experience succeed hence one can craft an actual physical item and therefore feel especially uplifted!
- + Group size: 8-30
- + Duration: up to 2 hours (flexible)
- + Languages: Estonian, English, Finnish
- + Price: 48€ per person
- + Additional services: solo bag making workshop



PROTO Adventures in the Invention Labyrinth

- + Location: Tallinn
- + Website: [PROTO Invention Factory](https://www.protofactory.ee)
- + Contact: info@protofactory.ee, +372 627 7600
- + Group size: 10–200 participants (divided into teams)
- + Duration: 45 minutes (game) + optional additional time in the exhibition
- + Languages: Estonian, English
- + Price:
 - + 10–50 participants — 28 € / person
 - + 51–100 participants — 1200 € / group
 - + 101–200 participants — 1700 € / group
- + Additional services: Access to PROTO exhibition, event hosting, Christmas parties, catering services, meeting room rental, guided programmes and custom team-building packages



Põhjala Brewery Tour

- + Location: Tallinn
- + Website: [Beer Restaurant Põhjala Tap Room and Brewery](#) | [Visit Estonia](#)
- + Contact: shop@pohjalabeer.com;
taproom@pohjalabeer.com
- + Main service: Brewery tours with degustation
- + Group size: 10-25pax
- + Duration: 45-60min
- + Languages: Estonian, English (Finnish & Russian depending on availability)
- + Price: 20€ per person, with a minimum fee of 225€
- + Additional services: table bookings at Põhjala Tap Room, Põhjala sauna



Poco Art Museum

- + Location: Tallinn
- + Website: [PoCo - Pop-Art Museum | Visit Estonia](https://www.poco.art)
- + Contact: book@poco.art
- + Main service: Pop Art museum; a selection of museum tours
- + Group size: 30
- + Duration: 1h
- + Languages: Estonian, English
- + Price: 18€ (Adult ticket)
- + Additional services: Private tours with a glass of bubbly; Kids play mornings; hosting private events



Liviko Distillery

- + Location: Tallinn
- + Website: [Liviko Distillery classic tour | Visit Estonia](#)
- + Contact: livikodistillery@liviko.ee, ph (+372) 506 7874
- + Main service: Liviko Distillery Tour with Tasting. Includes: Distillery visit in the historic Liviko complex, Interactive Museum visit, Tasting, Discounts at Liviko's flagship store
- + Group size: 6-10 people (strictly max 10 people due to food safety rules)
- + Duration: 1.5 hours
- + Languages: Estonian, English
- + Price: 25 eur per person
- + NB! Tour guests must be at least 18 years of age or older, no exception.



Estonian Open Air Museum

- + Location: a 15-minute drive from the centre of Tallinn
- + Website: [Estonian Open Air Museum | Visit Estonia](https://www.evm.ee)
- + Contact: info@evm.ee
- + Main service: Guided tour
- + Group size: max 25 people
- + Duration: 1,5 hour
- + Languages: English, German, French, Finnish, Russian, Spanish, Portuguese, Japanese, Italian, Polish, Hungarian, Lithuanian, Latvian and Swedish
- + Price: 110 € (incl. VAT) + tickets
- + Additional services: Catering (Kolu Inn), Horse-drawn carriage rides (max 8 persons), Folk Shows



City bike tours

- + Location: Tallinn
- + Website: [City Bike — bicycle rental | Visit Estonia](#)
- + Contact: Toomas Lelov, toomas@citybike.ee
- + Main service: Bicycle tour package with accommodation
- + Group size: 2-14
- + Duration: 4 days/ 3 overnights
- + Languages: Interactive guide, 8 different languages, AI translation (navigation App)
- + Price: from 366 EUR
- + Additional services: Bicycle/e-bike rental, extra gear rental, transport tickets, luggage transfer
- + Additional tour: West-Estonia and islands Self Guided bicycle tour package with accommodation (10 days/ 9 overnights): Self-guided bicycle tour Western Estonia and Islands



Tallinn TV Tower

- + Location: Tallinn
- + Website: [A walk on the edge of the roof of the Tallinn TV Tower, 175 m from the ground! | Visit Estonia](#)
- + Contact: +372 5911 9335 teletorn@teletorn.ee
- + Main service: 360 degree view with a perspective from high above (170 meters)
- + Group size: Up to 100 people are allowed to the Tv-Tower at a time
- + Duration: 1 hour
- + Languages: Estonian, English, Finnish
- + Price: 14€ - 45€
- + Additional services: Restaurant, Walk on the Edge, Photobooth, VR-flight, Northern Europe's Highest Open Viewing Platform (175 meters)



A Unique Curling Experience

- + Location: Tallinn
- + Website: [Tallinn Curling Club](http://TallinnCurlingClub)
- + Contact: hello@curlingtallinn.ee
- + Group size: Our private sessions are designed for groups of 6 to 60 people.
- + Duration: 2–3 hours of active fun.
- + Languages: English, Estonian, Finnish, Russian.
- + Price: Starting from 464 euros. Price includes all necessary equipment and expert guidance.
- + Additional information: Curling is the ultimate team game - easy to learn, yet full of strategic depth. It's an inclusive and engaging way to bring people together, regardless of age or fitness level. You don't need any previous experience—our professional instructors will guide you through the basics, ensuring your team is playing and competing from the very first throw.



visit
estonia

Harju-, Lääne-, Rapla County

Tallinn Viimsi Spa Hotel & Aquapark

- + Distance: Tallinn – Tallinn Viimsi Spa Hotel ~12 km
- + Driving time: ~20–25 min drive
- + Website: [Tallinn Viimsi Spa Hotel & Aquapark | Visit Estonia](#)
- + Contact: Kristi Puusepp, Sales Manager
kristi.puusepp@spatallinn.ee
- + Opening: Year-round
- + Rooms: 115 room, including family rooms, suites and rooms for disabilities
- + Main services: A beauty and wellness centre, H2O waterpark, adult spa 18+
- + Price: The accommodation price includes a visit to the swimming pool, gym, spa and sauna centre, and the children's centre.
- + Additional services: Tallinn Viimsi SPA complex also includes a cinema and conference centre, the Black Rose English pub and fitness club



Arvo Pärt Centre

- + Distance: Tallinn — Arvo Pärt Centre ~40 km
- + Driving time: ~40–50 min drive
- + Website: [Arvo Pärt Centre | Visit Estonia](#)
- + Contact: Nele Kivisild, Communication Manager
nele.kivisild@arvopart.ee
- + Opening: Year-round
- + Group size: 25 people for guided tours
- + Languages: English, Finnish, Russian
- + Main services: The work of Arvo Pärt has significantly changed our understanding of music and largely influenced the music around the world. This unique building is in line with composer Arvo's creative nature and is open to all music enthusiasts. The building includes a personal archive, a library, a 150-seat auditorium, an exhibition hall, a video room, and classrooms.
- + Duration: 1.5–2 hours
- + Price: €12 per person, guide fee €60
- + Additional services: Workshops, concerts, guided tours, creative residence for creators, recording studio



Picture by: Tõnu Tunnel

Hotel LaSpa

- + Distance: Tallinn — Tallinn Viimsi Spa Hotel ~35 km
- + Driving time: ~40–45 min drive
- + Website: [Hotel LaSpa](#) | [Visit Estonia](#)
- + Contact: Helen Vipper, Marketing Manager
helen.vipper@laspa.ee
- + Opening: Year-round
- + Rooms: 104 rooms + additional rooms in luxurious Beach house
- + Main services: LaSpa is a place to enjoy, move, relax, and be and feel healthy — both in mind and body. Hotel's great location in Laulasmaa amidst pine forests and sandy beaches. Hotel offers spa and sauna center. The award-winning WICCA restaurant with head chef Angelica Udeküll, and well-equipped bright conference rooms to host events 3-200 pax.
- + Additional services: Bike rental, discgolf course, surfing, group activities, beauti treatmens in NAUDI spa, gym



Rummu quarry

- + Distance: Tallinn — Rummu quarry ~50 km
- + Driving time: ~50 min drive
- + Website: [Rummu quarry | Visit Estonia](#)
- + Contact: Marketing Manager info@rummu.ee
- + Opening: Year-round
- + Group size: min 10 people for guided tours
- + Languages: English, Latvian, Russian
- + Main services: The crystal-clear light greenish blue lagoon of Rummu quarry and the adjacent artificial hill are an unbelievably unique combination and an extraordinary destination for a day trip. At the Rummu quarry the following awaits you: a hike around the mountain and amazing views, a water park, pedal boats, SUP boards, a summer cafe, a disc golf park, diving, sunbathing and swimming. Murru Prison tour available with an audio-guide or a tour guide. Entrance tickets can be purchased on gates 24/7.
- + Duration: 2 hours
- + Price: €7-10 per person, guide fee €20 per person
- + Additional services: Caravan park, luxurious container houses, campig cabins, self-service shop.

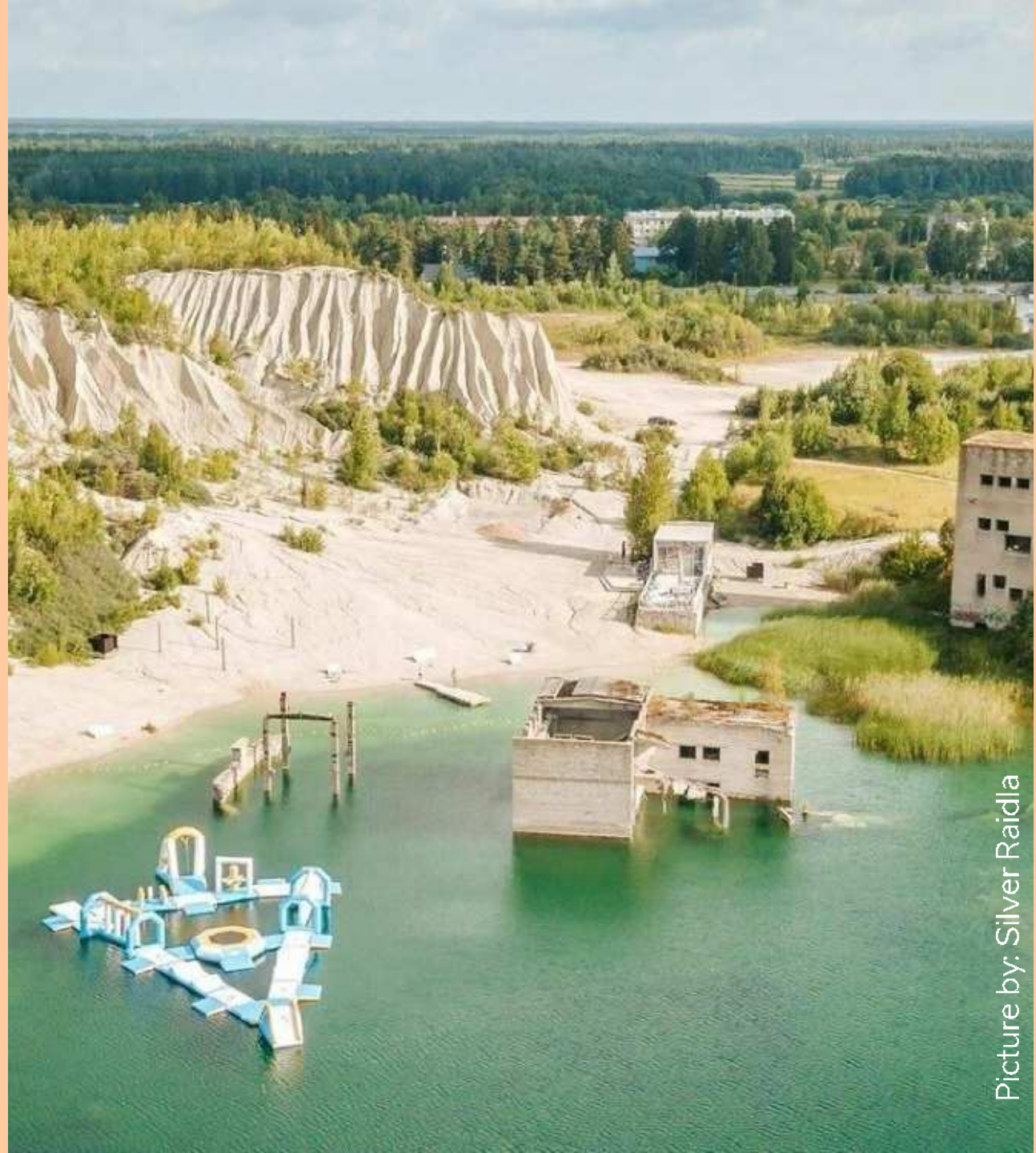

Keila-Joa Manor and Schloss Fall Museum

- + Distance: Tallinn – Keila-Joa Manor ~32 km
- + Driving time: ~40 min drive
- + Website: [Keila-Joa Manor and Schloss Fall Museum | Visit Estonia](#)
- + Contact: Nele Dvorjaninov info@schlossfall.com
- + Opening: Year-round
- + Languages: English, Russian, German, Finnish
- + Main services: The entire hotel complex accommodates up to 48 guests in 14 rooms+ 5 suites. Restaurant and a museum which consists of the castle history and different seasonal exhibitions. Picturesque view of the Keila-Joa waterfall.
- + Group size: 25 people
- + Price: €18 per person, guide fee €80
- + Duration: 1,5 h
- + Additional services: Guided tours available



Submarine base at Hara harbour

- + Distance: Tallinn-Hara harbour 64 km
- + Driving time: ~60 min drive
- + Website: [Submarine base at Hara Harbor | Visit Estonia](https://visitestonia.com/en/submarine-base-at-hara-harbor)
- + Contact: <https://visitestonia.com/en/submarine-base-at-hara-harbor>
- + Opening: Year-round
- + Group size: 6—40 people (standing tastings up to 50)
- + Languages: English, Finnish, Russian
- + Main service: Former military base. On the island of Hara, the famous 'Tallinn sprats' were manufactured under the leadership of V. R. Sörensen. You can also visit the photo exhibition 'Mysterious Harbour'. Guided tours takes you back to the Soviet times, it will also become clear why the Hara submarine base was so secret and you will learn what demagnetization means. Arranged tour by boat to the Hara island (1,5hrs).
- + Duration: 1 hour
- + Price: €14 per person from 30+ people
- + Additional services: Igloo sauna and smoke saunas for rent, private accommodation in fisherman huts (4pax) or igloo camping cabins (2pax), restaurant accommodates 50 pax

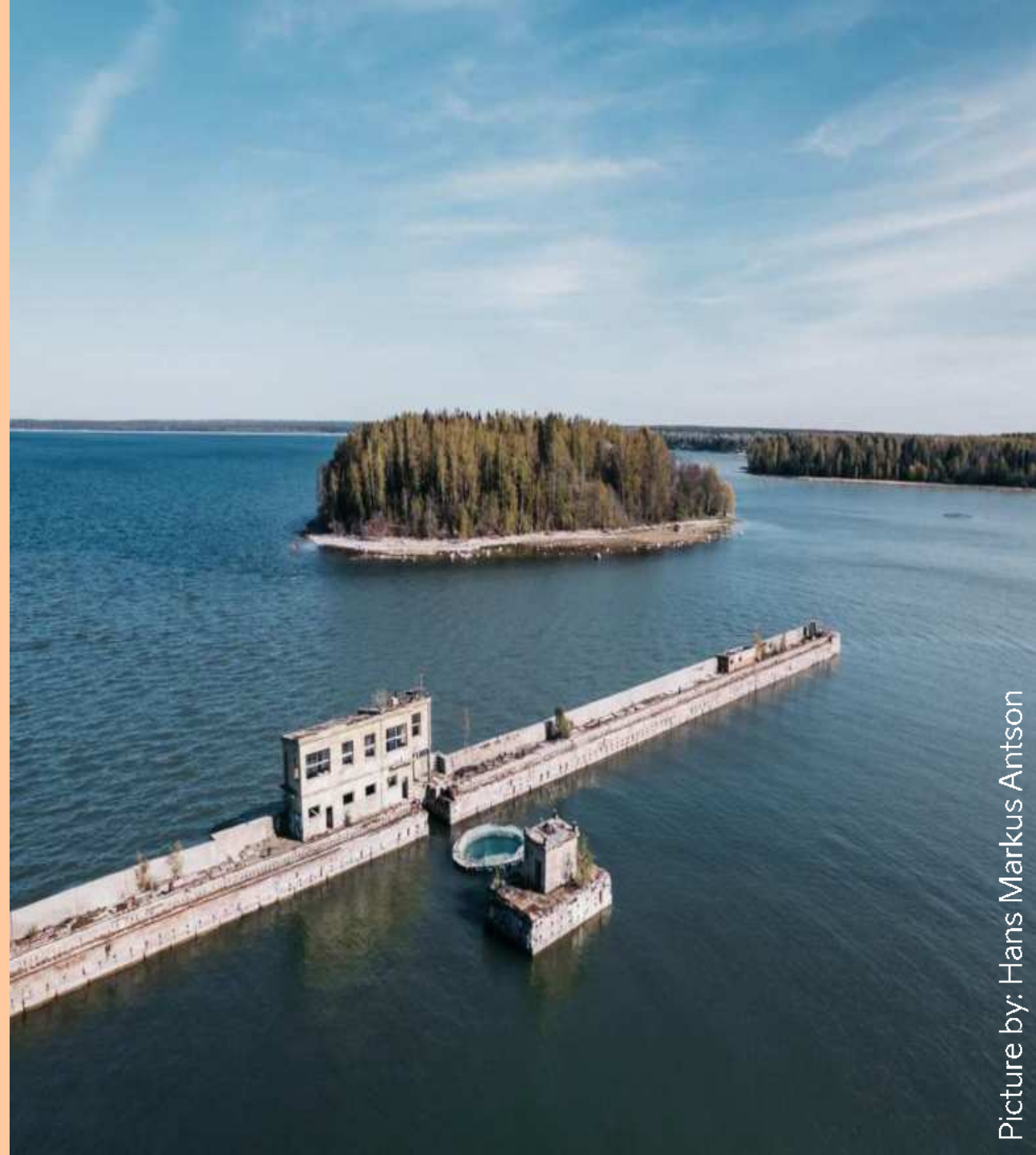

Conventual Building- Museum and Cathedral of the Haapsalu Episcopal Castle

- + Distance: Tallinn — Haapsalu ~100 km
- + Driving time: ~1,5h
- + Website: <https://visitestonia.com/en/haapsalu-castle-museum>
- + Contact: Egon Erkmann, egon.erkmann@salm.ee
- + Opening: Year-round
- + Languages: English, Russian, Finnish
- + Main services: The museum in the main castle focuses on the history of the castle itself. You can learn about the construction of the castle, the birth of the town of Haapsalu, and the fate of the rulers and locals of the Bishopric of Ösel–Wiek.
- + Group size: ~25 people
- + Price: €12 per person, guide fee €90
- + Duration: 1,5 h
- + Additional services: Guided tours available



Ilon's Wonderland

- + Distance: Tallinn – Haapsalu ~100 km
- + Driving time: ~1,5h
- + Website: <https://visitestonia.com/en/ilons-wonderland>
- + Contact: Egon Erkmann, egon_erkmann@salm.ee
- + Opening: Year-round
- + Languages: English, Russian, Finnish, German
- + Main services: Theme museum for children and families that showcases the work of Ilon Wikland, the illustrator of Astrid Lindgren's children's books.
- + Group size: ~25 people
- + Price: €10 per person, guide fee €40
- + Additional services: From May to August, the Wonderland courtyard is open. Inside you'll find Mattias's cottage and a handicrafts workshop. In the courtyard, you can try your hand at target throwing, stilt-walking, fishing, acting, and sandbox games.



Hestia Hotel Haapsalu Spa

- + Distance: Tallinn — Haapsalu ~100 km
- + Driving time: ~1,5h drive
- + Website: <https://visitestonia.com/en/hestia-hotel-haapsalu-spa-1>
- + Contact: Krista Hein, krista.hein@hestiahotels.com
- + Opening: Year-round
- + Languages: English, Finnish, Estonian
- + Main services: Hestia Hotel Haapsalu Spa, surrounded by the sea on three sides, offers beautiful nature views. Hotel offers relaxing moments for family, friends, couples, and seminar guests.
- + Rooms: 100 rooms, all rooms are suitable for allergy sufferers.
- + Price: The room rate includes a rich breakfast, unlimited access to the water and sauna spa, and fast WiFi.
- + Additional services: Restaurant, beauty center and wellness spa.

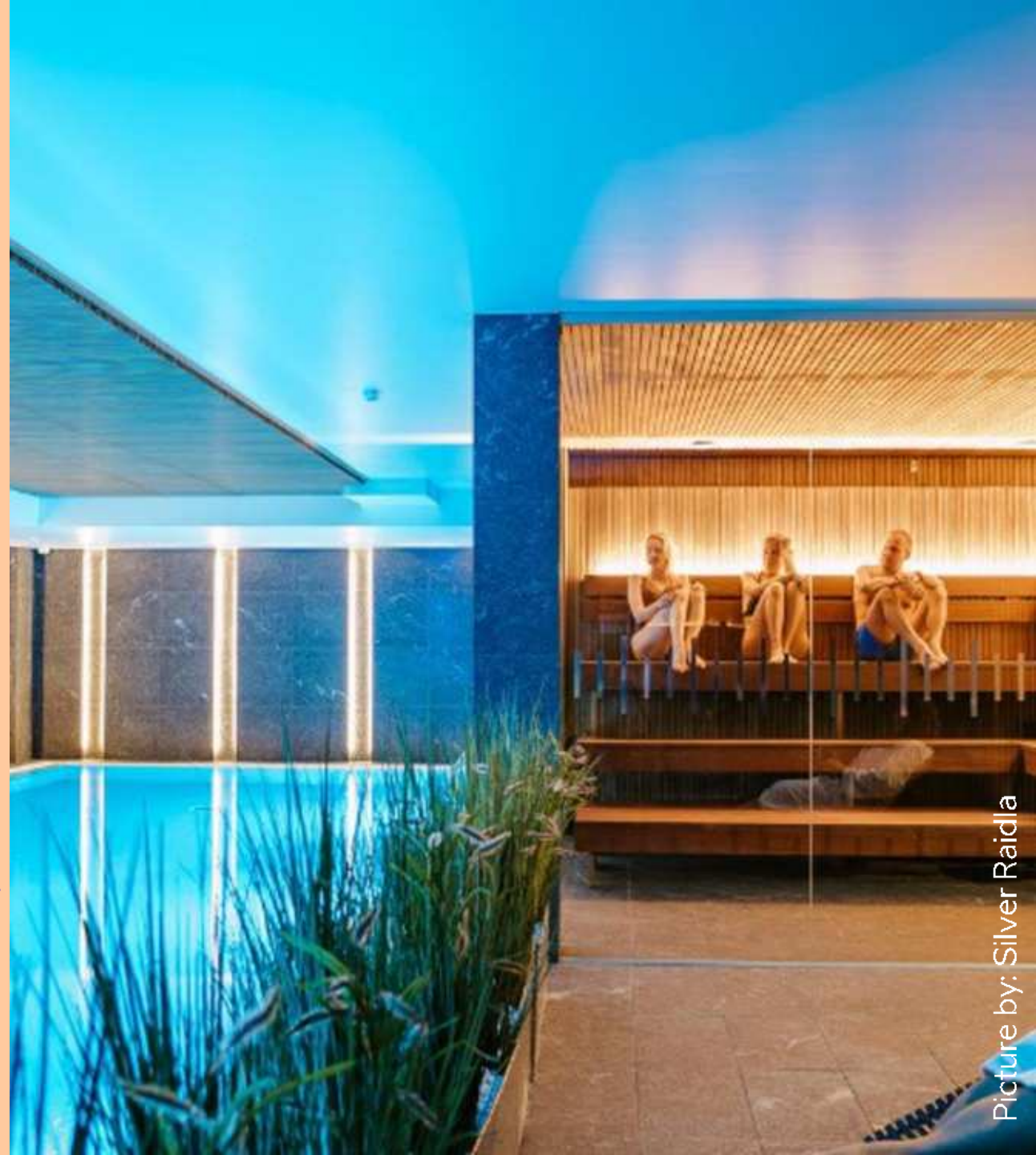

Tohi Distillery

- + Distance: Tallinn — Tohi Distillery ~30 km
- + Driving time: ~30–35 min drive
- + Website: <https://visitestonia.com/en/tohi-distillery-tour>
- + Contact: info@tohigin.com, +372 525 3554
- + Opening: Year-round, advance booking required
- + Group size: 8–35 people (larger groups on request)
- + Languages: Estonian, English (other languages on request)
- + Main service: Distillery tour, introduction to gin production, tasting of TOHI gins + cocktail
- + Duration: 1.5–2 hours
- + Price: From €20–30 per person (depending on tasting package), guide included
- + Additional services: Lunch and dinner, cocktail workshops, seminars and meetings, restaurant and bar, terrace events, accommodation in 2 distillery apartments



visit
estonia

The Central Estonia

Põltsamaa Castle

- + Distance: from Viljandi ~50 km, Tartu ~60 km, Tallinn ~120 km
- + Driving time: Viljandi ~40 min, Tartu ~1 hr, Tallinn ~1 hr30min
- + Website: [Põltsamaa Museum](#)
- + Contact: loss@poltsamaa.ee
- + Opening: Year-round
- + Group size: max 30 pax per guide
- + Languages: Estonian, English, Finnish, Russian, German
- + Main service: Guided tour of the castle museum incl observation tower
- + Duration: 1-2 hours
- + Price: 13 € per person, guide 50 € per group per hour
- + Additional services: catering and wine tasting at the castle restaurant; visit to the craft workshops; various buildings, incl church, open for exploration.



Picture by: Raivo Laanes

Wittenstein Activity Museum

- + Distance: from Tallinn ~90 km, from Tartu ~100 km
- + Driving time: ~1 hr drive from Tallinn, ~1hr15min from Tartu
- + Website: Wittenstein Activity Museum
- + Contact: info@wittenstein.ee
- + Opening: Year-round
- + Group size: min 6, max 30
- + Languages: English, Russian, German, Lithuanian, Finnish
- + Main service: immersive 19th-century experience of a small-town environment with authentic objects, exciting activities, and modern digital solutions
- + Duration: 1-1.5 hours
- + Price: 11 € per person, guide 40 € per group
- + Additional services: various workshops and tastings; also visit to Time Centre Wittenstein (former part of Paide Order Castle), walking tour of the Old Town of Paide, lunch or dinner in the museum's tavern hall



Toosikannu Nature Resort

- + Distance: from Tallinn ~90km, from Paide 35 km
- + Driving time: from Tallinn ~1hr 30min, from Paide 35 min
- + Website: Toosikannu Nature Resort
- + Contact: info@toosikannu.ee
- + Opening: Year-round
- + Size: 72 rooms (in various buildings)
- + Main service: Estonia's largest nature resort — wildlife safaris and seasonal tours, various accommodation options, catering, wide variety of activities for groups
- + Additional services: conference centre for 400 pax, event services, various saunas



Stroller Museum in Käru

- + Distance: from Tallinn ~85km, from Paide ~30 km
- + Driving time: from Tallinn ~1hr 20min, from Paide ~30 min
- + Website: [Stroller Museum in Käru](#)
- + Contact: karumuuseum@gmail.com
- + Opening: Year-round, by prior appointment
- + Group size: min 10, max 45
- + Languages: English, Russian, Finnish
- + Main service: tour of the museum's permanent exhibition of prams incl story of the community; also temporary exhibitions
- + Duration: 1-1.5 hours
- + Price: 10 € per person, guide 40 € per group
- + Additional services: catering; accommodation in historical flats



Wile Alpaca Farm

- + Distance: from Tallinn ~100 km, from Paide 13 km
- + Driving time: ~1hr 20min drive from Tallinn, 15min from Paide
- + Website: Wile Alpaca Farm
- + Contact: info@wile.ee
- + Opening: Year-round, by prior appointment only
- + Group size: min 10, max 60
- + Languages: English, Russian
- + Main service: farm visit including shopping opportunity of various local handicraft items made from alpaca wool
- + Duration: ~ 1 hour
- + Price: 7 € per person (min group size 10)

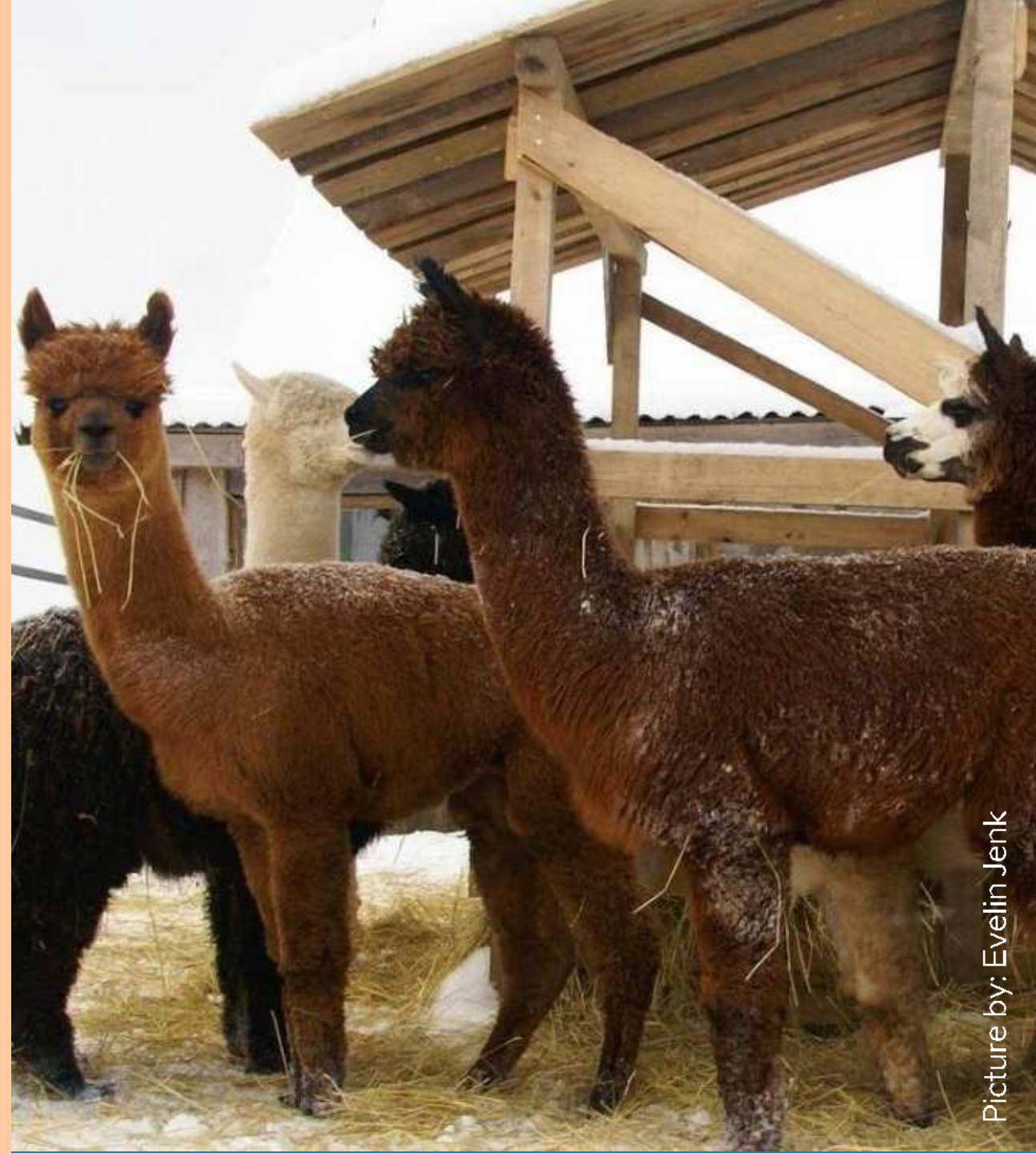

Kondas Centre

- + Distance: from Tallinn ~155 km, from Tartu ~80 km
- + Driving time: ~2 hr drive from Tallinn, ~1hr10min from Tartu
- + Website: Kondas Centre
- + Contact: kondas@kondas.ee
- + Opening: Year-round
- + Group size: min 10, max 24; larger groups possible by special arrangement
- + Languages: English, Russian
- + Main service: tour of the museum dedicated to outsider art incl permanent as well as temporary exhibitions; an important cultural landmark with the story behind the strawberries scattered around the town of Viljandi
- + Duration: ~45 min
- + Price: 4 € per person, guide 20 € per group
- + Additional services: museum shop, hands-on art workshops



Estonian Traditional Music Center in Viljandi

- + Distance: from Tallinn ~155 km, from Tartu ~80 km
- + Driving time: ~2 hr drive from Tallinn, ~1hr10min from Tartu
- + Website: [Estonian Traditional Music Centre](http://EstonianTraditionalMusicCentre)
- + Contact: inga.ronk@folk.ee
- + Opening: Year-round
- + Group size: min 8, max 25, larger groups possible by special arrangement
- + Languages: English, Finnish, Swedish
- + Main service: tour of the historical granary building with an insight into the Estonian traditional music scene from its original roots to mainstream and international success
- + Duration: ~45 min
- + Price: 6 € per person
- + Additional services: workshops of musical instruments, singing and folk dance; also lunch or dinner in Aida Café at the centre's top floor with scenic views



Mulgi Brewery

- + Distance: from Viljandi ~35 km
- + Driving time: ~30 min drive from Viljandi
- + Website: Mulgi Brewery
- + Contact: info@mulgipruul.ee
- + Opening: Year-round, by prior appointment only
- + Group size: min 10, max 35; larger groups possible by special arrangement
- + Languages: English, Russian
- + Main service: visit to the microbrewery and tasting of local beers
- + Duration: ~1 hour
- + Price: 14 € per person
- + Additional services: catering, live music



Taagepera Castle's enchanted park "Alice and the Wonderland of a Million Flowers"

- + Distance: from Viljandi ~50 km, Tartu ~90 km, Riga ~200 km
- + Driving time: Viljandi ~40 min, Tartu ~1h15min, Riga ~2h50min
- + Website: [Taagepera Castle's enchanted park](#)
- + Contact: info@wagenkull.ee, tel: +372 766 6390
- + Opening: 2026 season from June 18 until September 27
- + Group size: min 12, max unlimited
- + Languages: Estonian, English, Russian, Latvian
- + Main service: theme park visit
- + Duration: 2 hours
- + Price: 12 € per person
- + Additional services: summer café, restaurant, SPA, hotel, castle tower, manor tour



Mulgi Experience Centre

- + Distance: from Viljandi ~50 km, Tartu ~85 km, Riga ~ 200 km
- + Driving time: Viljandi ~40 min, Tartu ~1h10min, Riga ~2h50min
- + Website: [Mulgi Experience Centre](https://mulgielamuskeskus.ee)
- + Contact: jaanika@mulgielamuskeskus.ee, tel: +372 5086856
- + Opening: Year-round, groups by prior appointment
- + Group size: if with group discount, then min 20, without no min limit. Max 30.
- + Languages: Estonian, English, Russian, Latvian
- + Main service: story of the unique cultural region Mulgimaa, the essence of Mulgi people and their heritage, mythology and traditions including the UNESCO-listed Mulgi porridge
- + Duration: ~1 hour
- + Price: 12 € per person, guide 120 € per group
- + Additional services: workshops



Shroomwell Factory Tour and Degustation

- + Distance: from Viljandi ~50 km, Tartu ~70 km, Riga ~ 200 km
- + Driving time: Viljandi ~50 min, Tartu ~1h, Riga ~2h50min
- + Website: [Shroomwell](https://shroomwell.com)
- + Contact: info@shroomwell.com tel: +372 5323 3135
- + Opening: Year-round, by prior appointment only
- + Group size: min 10, max 50
- + Languages: English
- + Main service: guided tour of one of the biggest indoor functional mushroom cultivators in Northern-Eastern Europe and tasting of products with shopping opportunity
- + Duration: ~1.5 hour
- + Price: 12 € per person



visit
estonia

Tartu & South Estonia

ERM (Estonian National Museum)

- + Location: Tartu
- + Driving time: Tallinn- Tartu, 2h
- + Website: [Estonian National Museum | Visit Estonia](#)
- + Contact: Liina Kuzemtšenko, Sales & Service Manager, liina.kuzemtsenko@erm.ee
- + Opening: Year-round
- + Group size: max 25
- + Languages: English, Russian, German, Finnish, Swedish, Latvian, Lithuanian, Spanish, French, Mordvin, Udmurt, and Mari.
- + Main service: The largest museum in Estonia with nearly 6,000 m² of exhibition space. Discover the everyday life of Estonians throughout history at the permanent exhibition 'Encounters' and learn about the life of the Finno-Ugric peoples in the permanent exhibition 'Echo of the Urals'. The museum experience is complemented by temporary exhibitions.
- + Duration: 60 min/90 min/120 min
- + Price: At the customer's choice, on the Estonian or Finno-Ugric permanent exhibition, or in temporary exhibitions
Duration 60 minutes: €70/group, plus the group ticket price
- + On both the Estonian and Finno-Ugric permanent exhibitions (recommended for school groups)
Duration 90 minutes: €100/group, plus the group ticket price
- + On both the Estonian and Finno-Ugric permanent exhibitions (recommended for adult groups)
Duration 120 minutes: €130/group, plus the group ticket price
- + Additional services: The museum has restaurant, museum shop, a modern conference centre and venue for international events.



A Le Coq Beer Museum

- + Location: Tartu
- + Driving time: Tallinn- Tartu, 2h
- + Website: [A. Le Coq Beer Museum | Visit Estonia](#)
- + Contact: Annika Teder, annika.teder@alecoq.ee
- + Opening: Year-round
- + Group size: max 25
- + Languages: In Estonian, English or Russian
- + Main service: The museum tells the story of the world and Estonian beer brewing from ancient Egypt to the present day. In addition, visitors can take a detailed look at all the ingredients of beer, become familiar with the process of beer making, and see old production equipment. The heart of the museum is the historical malt tower, where A. Le Coq's 200-year-old exciting story unfolds.
- + Duration: 90 min
- + Price: Guided tour 50€
- + Additional services: At the end of the visit, visitors can enjoy a cold beer or lemonade at the museum bar and visit gift shop.

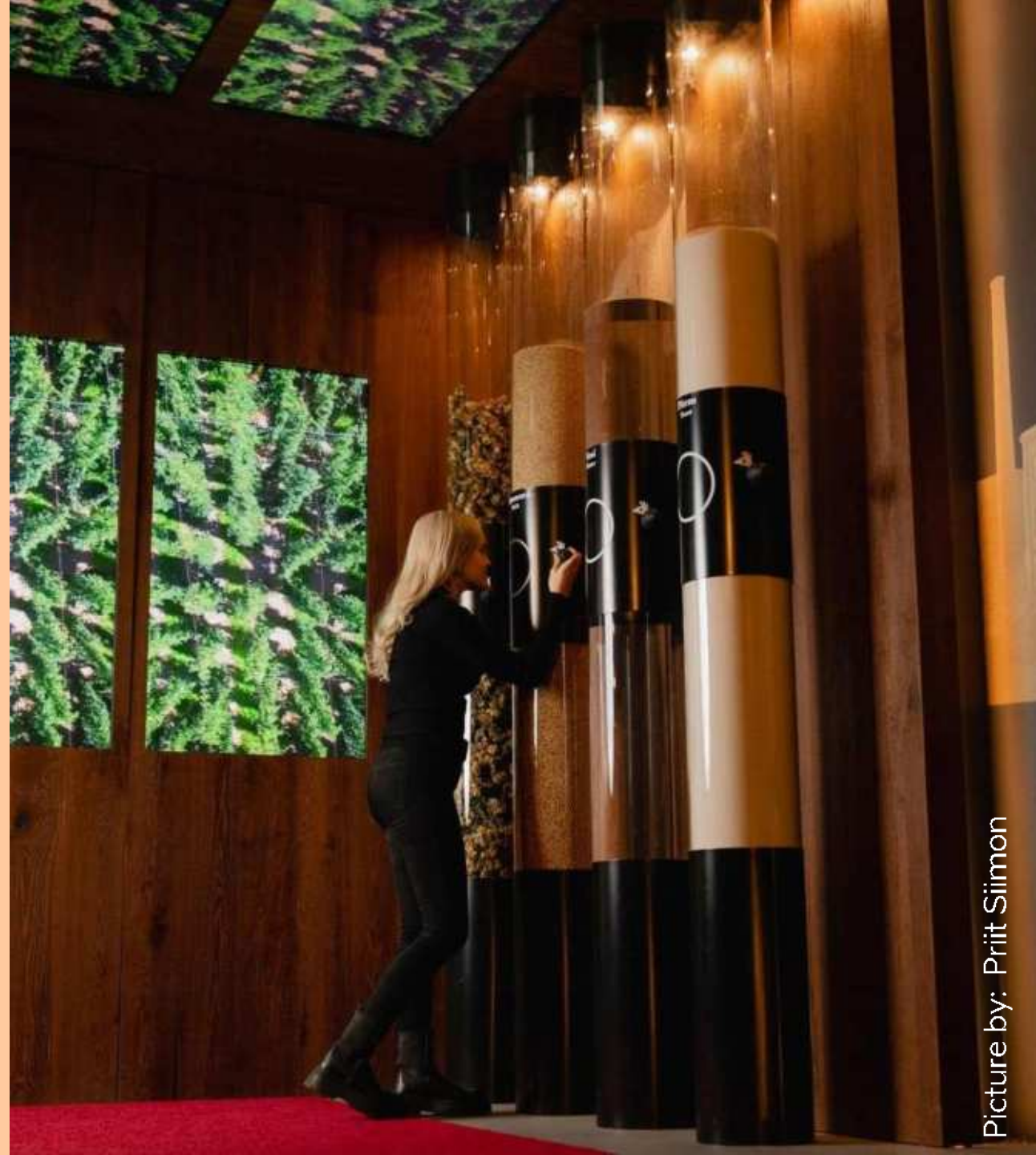

Lodjakoda & the "Suur Sume" barge

- + Location: Tartu
- + Driving time: Tallinn- Tartu, 2h
- + Website: [The 'Suur Sume' barge | Visit Estonia](#)
- + Contact: Liisa-Lota Kaivo, info@lodi.ee
- + Opening: Year-round
- + Group size: 40
- + Languages: In Estonian, English
- + Main service: At the Lodjakoda (Barge Chamber) everyone can see how a 24 m long two-masted Emajõgi-Peipsi barge is built. On big screen you can watch barge chronicles and slide shows. In addition, everyone is welcome to craft a barge model, learn sailor wisdom, visit a smithy, try old-fashioned barge-related work, and study the history of barge shipping. The "Suur Sume" barge is the largest wooden sailing ship built in the Baltic States after World War II.
- + Duration: 45 min
- + Price: 90€
- + Additional services: The Barge Chamber operates as a shipbuilding centre, theme park, museum, conference centre, and exhibition space with a café, Viking and barge tours, and a harbour.



University of Tartu Museum

- + Location: Tartu
- + Driving time: Tallinn- Tartu 2 h
- + Website: [The Univeristy of Tartu Museum](https://www.muuseum.ut.ee)
- + Contact: muuseum@ut.ee
- + Opening: Year-round
- + Languages: Estonian, English, German
- + Main service: The University of Tartu Museum introduces the history of science and university education from the 17th century to the present day and tells the exciting story of Tartu Cathedral.
- + Duration: 1-1.5 h
- + Price: 60€
- + Additional services: The Old Observatory tour



Kolkja Museum of Old Believers

- + Distance: Tartu – Kolkja 40 km
- + Driving time: ~35 min drive from Tartu
- + Website: [Kolkja Museum of Old Believers | Visit Estonia](#)
- + Contact: info@vanausulistemuuseum.ee tel: +372 5662 3980
- + Opening: Year-round
- + Group size: 15-40
- + Languages: English, Russian
- + Main service: muuseum (The Kolkja Museum of Russian Old Believers in the Kolkja village researches the story of Old Believers by Lake Peipsi and tells that story)
- + Duration: 1 hours
- + Price: €11 per person (groups €9), guide €30 (EST, RUS)
- + Additional services: hands-on food workshops 5-15 persons (onion pie, traditional local sugar candy, cookies)



Kalevipoeg's Home

- + Distance: Tartu — Kääpa ~40 km
- + Driving time: ~40 min drive
- + Website: [Kalevipoeg's Home | Visit Estonia](#)
- + Contact: info@kalevipojakoda.ee, tel: +372 5886 6805
- + Opening: Year-round
- + Group size: 12–50 people
- + Languages: English, Russian
- + Main service: Museum, excellent overview of the Estonian national epic "Kalevipoeg."
- + Duration: 1.5 h
- + Price: €25 per person, guide free of charge
- + Additional services: virtual reality (€7 per person), group menu, seminars, adventure park (€17 per person)



Avinurme woodworking centre

- + Distance: Jõgeva — Avinurme ~50 km
- + Driving time: ~45 min drive
- + Website: [Avinurme Woodworking Centre | Visit Estonia](#)
- + Contact: info@puiduait.ee, tel: +372 527 5762
- + Opening: Year-round
- + Group size: 5-50
- + Languages: English, Russian
- + Main service: shop with largest selection of wooden crafts in Estonia
- + Duration: 1 hour
- + Additional services: craft workshops starting €16 per person, catering for groups, train ride on historic railway (1-12 pax €60, 13+ per person €5)



Picture by: Andres Razik

Estonian Road Museum

- + Distance: Tartu — Varbuse ~48 km
- + Driving time: ~45 min drive
- + Website: [Estonian Road Museum | Visit Estonia](#)
- + Contact: maanteemuuseum@transpordiamet.ee, tel: +372 5802 3449
- + Opening: Year-round
- + Group size: 12-50
- + Languages: English, Russian, Finnish, German, Latvian
- + Main service: museum (The outdoor exhibition Road Time, Machinery Hall, Varbuse Post Station)
- + Duration: 1 hours
- + Price: €14 per person, guide €60 (1 hour)
- + Additional services: seminars, group catering



KODAS drinks and food production tour and cider tasting

- + Distance: Tartu – Valgjärve ~45 km
- + Driving time: ~40 min drive
- + Website: [KODAS drinks and food production tour and cider tasting | Visit Estonia](#)
- + Contact: info@kodas.ee, tel: +372 5331 1618
- + Opening: Year-round
- + Group size: 10-40
- + Languages: English
- + Main service: The KODAS modern production handcrafted ciders, sparkling wines, and non-alcoholic drinks, distance working and restaurant
- + Duration: 1,5-2 hour
- + Price: factory tour €19 (3 drink degustation), €24 (6 cider or 3 sparkling wine degustation) min. price €120
- + Additional services: catering for groups



Museums of Setomaa

- + Distance: Tartu — Värska ~90 km, Värska-Obinitsa 30 km
- + Driving time: ~75 min drive
- + Website: [Värska Farm Museum | Visit Estonia](#)

[Obinitsa Museum | Visit Estonia](#)

- + Contact: myyk@setomuuseum.ee, tel: +372 505 4673
- + Opening: Year-round
- + Group size: 16-50
- + Languages: English, German, Russian
- + Main service: Värska Farm Museum enables the visitors to learn about setos through the life in Seto farm, Obinitsa Museum offers an opportunity to learn about the unique history and culture of Setomaa through exploring the family life, traditions and customs of Seto families.
- + Duration: 2 hour
- + Price: 8€ per person, guided 1 h tour €60
- + Additional services: in Värska: museum shop, catering [Café Seto Tsäimaja | Visit Estonia](#), concert of Leelo choir
In Obinitsa Seto culture workshop [Putting on Seto clothes](#), village chappel



Uue-Saaluse Winery

- + Distance: ~40 km
- + Driving time: ~35–40 min drive
- + Website: [Uue-Saaluse Winery](#) | [Visit Estonia](#)
- + Contact: info@uuesaaluseveinitalu.ee, tel: +372 5183249
- + Opening: Year-round
- + Group size: 6–30 people
- + Languages: English, Russian
- + Main: a year-round educational 'wine tour', during which we will explore the secrets of wine-making and then, taste three wines with snacks.
- + Duration: 2 hours
- + Price: €22 per person (min. price 132€)
- + Additional services: Lunch and dinner (€29–37 per person), smoke sauna experience (2–8 pax 350€)



Picture by Uue-Saaluse-Saaluse Winery

Murimäe Wine Cellar and Vineyard

- + Distance: Otepää — Murimäe ~14 km, Tartu — Murimäe 57km
- + Driving time: ~15 min drive (Tartu ~55min)
- + Website: [Murimäe Wine Cellar and Vineyard | Visit Estonia](#)
- + Contact: info@murimaevein.ee, tel: +372 5065864
- + Opening: May–October
- + Group size: 6–20 people (max 40)
- + Languages: English, Russian
- + Main : The secret to good wine is hidden in Murimäe — local, carefully selected ingredients, the sunny hillside of Otepää, northern climate. Tour to the vineyard and tasting 5 wines.
- + Duration: 1,5–2 hours
- + Price: €25 per person (min 150€)
- + Additional services: Lunch and dinner (€25–35 per person), team building activities (35€ person) workshops



Kicksledge or kickbike hikes by Lake Pühajärv

- + Distance: Tartu – Otepää ~40 km
- + Driving time: ~40 min drive
- + Website: [Kick sledge hike on the ice of Lake Pühajärv or along the sports tracks](#) | [Visit Estonia](#)
- + Contact: info@loodusturism.ee, tel: +372 5272701
- + Opening: Year-round
- + Group size: 10-80 people
- + Languages: English, Finnish, Latvian
- + Main: Hikes in Otepää nature park. During the 2–4 hour hike, we will cover about 7 km of winter roads. The guides add fun to the gathering breaks with games and exciting tales about nature. In the summer we use kick-bikes. Riding a kick-bike is fun, easy, and exciting. Use one foot to add speed and the second to keep your balance.
- + Duration: 2-4 hours
- + Price: €25-30 per person, guide included
- + Additional services: FAT bikes, canoe, raft; in different locations in South-Estonia as well



visit
estonia

Pärnu, West Estonia

Hedon spa – Silent spa

- + Distance: Hedon SPA & Hotel in Pärnu beach
- + Driving time: ~5min drive from Pärnu city center; ~1 hour 45 min from Tallinn.
- + Website: <https://visitestonia.com/en/hedon-spa>
- + Contact: sales@hedonspa.com; +372 44 99 021
- + Opening: Year-round
- + Group size: 24 people
- + Languages: English, Estonian
- + Main service: A modern boutique spa in a historically symbolic building hidden in the tunes of sand. A place where a journey begins enhanced with purification and vitality for body and spirit.
- + Duration: 2–3 hours
- + Price: For hotel guests
Mon–Thu: €30
Fri–Sun: €35
- + For not hotel guests
Mon–Thu: €38
Fri–Sun: €50



Museum of New Art

- + Location: Rüütli 40a, Pärnu city center.
- + Driving time: Located in central Pärnu; ~1 hour 45 min from Tallinn.
- + Website: <https://visitestonia.com/en/museum-of-new-art>
- + Contact: muuseum@mona.ee, tel: +372 443 0772
- + Opening: June—August: Mon—Sun 11:00—18:00; September—May: Wed—Sun 11:00—18:00.
- + Group size: Flexible—suitable for individual visitors and large organized groups.
- + Languages: Estonian, English, Russian (guided tours available in multiple languages).
- + Main Services: Dynamic exhibitions of modern art (collection includes over 700 works). Extensive video theque with more than 1,200 documentary films. Annual traditional exhibitions like "Man and Woman" (nudes) and "Give a New Life" (recycling). Art shop featuring local designs and Pärnu's largest selection of postcards.
- + Duration: 1—1.5 hours.
- + Price: Full ticket: €8
- + Additional services: Guided tours for groups (upon pre-order), educational programs, and hosting of cultural events and screenings.



T-shirt making workshop at Black Giraffe Studio

- + Location: Rüütli street, Pärnu city center (at the studio) or at a location of your choice.
- + Driving time: Located in the heart of Pärnu; ~1 hour 45 min from Tallinn.
- + Website: [T-shirt making workshop at Black Giraffe Studio](#)
- + Contact: kairi@blackgiraffe.ee, tel: +372 5199 6320
- + Opening: By advance booking (ideal for birthdays, team events, or friend gatherings).
- + Group size: 6–20 people (larger groups possible upon request).
- + Languages: Estonian, English
- + Main Services: Creative T-shirt printing workshop where everyone designs and makes their own shirt. No prior artistic skills required—the focus is on fun and creativity. Use of high-quality organic cotton T-shirts. A welcome drink and snacks are included to boost the creative spirit.
- + Duration: Approximately 2 hours.
- + Price: €40 per person (includes the workshop, T-shirt, snacks, and drinks).
- + Additional services: Personalized gift shop, custom-designed clothes (e.g., from children's drawings), and mobile workshop service (they can come to your event).



Pärnu Kalataksõ fishing trips

- + Location: Kalataksõ Jõekeskus, Pärnu city (Jõe 2).
- + Driving time: Located in Pärnu city; ~1 hour 45 min from Tallinn.
- + Website: [Pärnu Kalataksõ fishing trips](#)
- + Contact: info@kalataksõ.eu, tel: +372 5834 2222
- + Opening: All year round by advance booking (seasonal trips from spring to winter).
- + Group size: Up to 15 people at a time.
- + Languages: Estonian, English
- + Main Services: Guided fishing trips on Pärnu River and Pärnu Bay (targeting pike-perch, perch, pike, etc.). Winter fishing trips on the ice using a safe amphibious vehicle. Rental of high-quality fishing gear and safety equipment. Boat and pontoon rentals for independent exploration.
- + Duration: 3 to 5 hours (customizable upon request).
- + Price: Depends on the size of the inquiry (pricing varies based on group size, trip duration, and specific equipment needs).
- + Additional services: Professional fishing guide tips, transport to the best fishing spots, and tailored packages for corporate events or families.



Porsche Ring

- + Location: Audru, Pärnu County (approx. 8 km from Pärnu city center).
- + Driving time: ~10–15 min drive from Pärnu city center; ~1 hour 45 min from Tallinn.
- + Website: <https://visitestonia.com/en/porsche-ring-racetrack>
- + Contact: info@porschering.ee, tel: +372 5866 6636
- + Opening: April to October (main season), though events and driving experiences vary by weather.
- + Group size: Flexible—from individuals to corporate groups of over 100 people.
- + Languages: Estonian, English, Finnish, Russian
- + Main Services: * Track rentals for cars and motorcycles.
 - + "Taxi" rides with professional racing drivers.
 - + Supercar driving experiences (Porsche, Toyota GR Yaris, etc.).
 - + Safety driving training.
- + Duration: From 15-minute sessions to full-day corporate events.
- + Price: Track fees start at approx. €30—€50 for short sessions. Experience packages (e.g., Porsche driving) typically range from €150 to €500+.
- + Additional services: Conference rooms, sauna, catering, and a lounge area overlooking the track.



Klaara-Manni's cooking workshop

"We make it ourselves, we eat it ourselves!"

- + Location: Randivälja village, Tori Parish, Pärnu County.
- + Driving time: ~25 min drive from Pärnu city center; ~1 hour 45 min from Tallinn.
- + Website: [Klaara-Manni's cooking workshop "We make it and we eat it!,"](#)
- + Contact: info@klaaramanni.ee, tel: +372 5803 2913
- + Opening: All year round by advance booking only.
- + Group size: Flexible—suitable for small groups as well as larger corporate teams.
- + Languages: Estonian, English, Finnish, Russian.
- + Main Services: * Hands-on preparation of a 3-course meal using traditional recipes.
- + Focus on organic, local ingredients (vegetables, berries, and herbs).
- + Adaptable menus for various dietary needs (meat-eaters, vegetarian, vegan).
- + Sharing local stories while enjoying the self-made meal together.
- + Duration: several hours, depending on the group size and chosen menu.
- + Price: Quotes provided upon request based on group size and specific menu selections.
- + Additional services: Accommodation, seminar rooms, sauna, event catering, and guided nature tours.



Alpaca farm – the largest in Estonia

- + Location: Niidu village, Tori Parish, Pärnu County.
- + Driving time: ~20 min drive from Pärnu city center; ~1 hour 30 min from Tallinn.
- + Website: [Alpaca farm – the largest in Estonia!](#)
- + Contact: alpakafarmestland@gmail.com, tel: +372 5812 1151
- + Opening: June–August: Mon–Sun 10:00–18:00; September–May: Sat–Sun 12:00–15:00.
- + Group size: Flexible—open for individual visitors and large organized groups (advance booking required for groups).
- + Languages: Estonian, English, Finnish, Russian.
- + Main Services: * Visiting the farm to see and pet alpacas, pygmy goats, miniature sheep, and rabbits.
- + Feeding animals with farm-provided treats (carrots).
- + Farm shop featuring exclusive alpaca wool products and souvenirs.
- + Guided tours for groups (educational stories about alpacas and farm history).
- + Duration: 1–2 hours
- + Price: * Adults: €10; Treats for animals: €1 per cup
- + Additional services: Personal guided tours for groups, "dome house" rental for events, and educational workshops.



Wine tasting in Valgeranna Veinitall

- + Location: Ringi 13a, Audru, Pärnu (located in the historic Audru Manor complex).
- + Driving time: ~10–15 min drive from Pärnu city center; ~1 hour 45 min from Tallinn.
- + Website: [Wine tasting in Valgeranna Veinitall](#)
- + Contact: valgeranna@veinitall.ee, tel: +372 518 3158
- + Opening: All year round by advance booking only.
- + Group size: Flexible—suitable for small groups, tourists, and corporate events.
- + Languages: Estonian, English
- + Main Services: Tasting of Mamm & Frukt craft wines (up to 5 different wines, from sparkling to fruit wines). Tasting of award-winning Estonian grappa. Educational tours of the winery and the historic manor-era horse arena. Guided tours of the Audru Manor complex.
- + Duration: 1–1.5 hours
- + Price: Depends on the size of the inquiry (varies based on the selection of wines and additional tour options).
- + Additional services: Wine shop on-site, event hosting, and historical storytelling about the manor.



Jaanihanso cider tour

- + Location: Kaelase village, Põhja-Pärnumaa Parish, Pärnu County.
- + Driving time: ~35—40 min drive from Pärnu city center; ~1 hour 15 min from Tallinn.
- + Website: [Visit to Jaanihanso Cider House](#)
- + Contact: cider@jaanihanso.ee, tel: +372 512 0874
- + Opening: Factory shop open year-round (check Google profile for times); tours and events by advance booking.
- + Group size: Flexible—from small private groups up to 200 people for events and seminars.
- + Languages: Estonian, English.
- + Main Services: Guided tours of the cidery and organic apple orchard. Tasting of 5—6 different ciders and fruit sparkling wines (traditional Champagne-method). Event hosting (weddings, corporate summer/winter days, concerts).
- + Cooking workshops and team-building activities.
- + Duration: 1.5 hours for a tour and tasting
- + Price: Groups up to 15 people: €180 (minimum fee). Larger groups: €12 per person.
- + Catering (lunch or dinner) available upon pre-order for an additional fee.
- + Additional services: Seminar rooms (4 rooms, total capacity up to 350), on-site factory shop, large terrace, and romantic apple orchard for outdoor events.



A day filled with authentic Kihnu traditions

- + Location: Kihnu island, Pärnu County (meeting point typically at the port or as agreed).
- + Travel time: ~1 hour ferry ride from Munalaid port (which is ~40 min drive from Pärnu).
- + Website: [Tour of Kihnu with the tour guide Mare Mätas](#)
- + Contact: mare.matas@gmail.com, tel: +372 507 1453
- + Opening: All year round by advance booking only.
- + Group size: Flexible—from individuals to larger groups (tours can be done by car, van, or bicycle).
- + Languages: Estonian, English, Russian.
- + Main Services: Guided cultural tours of Kihnu island (UNESCO Intangible Cultural Heritage). Overview of Kihnu's unique traditions: language, handicrafts, folk music, and dancing. Visiting main attractions: the church, lighthouse, museum, and local villages. Insightful stories about the island's maritime history, seal hunting, and daily life.
- + Duration: 1 to 3 hours (customizable based on preference)
- + Price: €35 per hour (using the visitor's car or for a bicycle tour). €150 for a 3-hour tour using the guide's own car. For larger groups or special requests, price depends on the size of the inquiry.
- + Additional services: Coordination of traditional Kihnu meals, folklore performances, and handicraft workshops upon request.



visit
estonia

Islands Saaremaa & Hiiumaa

Kuressaare Castle

- + Distance: Kuressaare city centre to Kuressaare castle~700 m
- + Driving time: ~2 min drive
- + Website: [Kuressaare Episcopal Castle | Visit Estonia](#)
- + Contact: Piret Hiie-Kivi, Manager of permanent exhibitions and services, piret.hiie-kivi@samu.ee
- + Opening: Year-round (15. May-15. September open daily)
- + Languages: audio guides in English and Russian
- + Main services: history exhibition, temporary art exhibitions, guided tours every Sunday (15 pax maximum)
- + Price: ticket 13€, concession 10€
- + Additional services: authentic medieval bishop's dinners for groups



Saare KEK museum

- Distance: Kuressaare city centre to Saare KEK museum~2,5 km
- Driving time: ~5 min drive
- Website: [Saare KEK Centre & Museum | Visit Estonia](#)
- Contact: Helle Susi, Manager, info@saarekek.ee
- Opening: Year-round (1. June-31. August open daily)
- Languages: info in Estonian, English, Russian and Finnish
- Main services: exhibition about Soviet history
- Price: ticket 7.50€
- Additional services: escape rooms for team events (2 rooms and maximum 13 persons together), jazz concerts



Angla Windmills

- Distance: Kuressaare to Angla Windmills ~ 36 km
- Driving time: ~35 min drive
- Website: [Angla Windmill Mount | Visit Estonia](#)
- Contact: Anu Noor, sales assistant and host, angla@kylastuskeskus.ee
- Opening: Year-round (open daily)
- Languages: info in Estonian, English, Russian
- Main services: museum introducing local folk culture, historical agricultural machines, farm animals and birds
- Price: ticket 10€, concession 7€
- Additional services: different workshops (minimum 10 people), souvenir shop



Sõrve Lighthouse

- Distance: Kuressaare to Sõrve Lighthouse ~ 50 km
- Driving time: ~45 min drive
- Website: [Sõrve Lighthouse](#) | [Visit Estonia](#)
- Contact: Andro Roosileht, Manager, sorve.keskus@gmail.com
- Opening: 18. May to 06. September open daily (other times by appointment)
- Languages: info in Estonian, English
- Main services: beautiful views from the top of the lighthouse, museum introducing maritime history
- Price: ticket 7€, concession 5€
- Additional services: souvenir shop



Leedri village tour

- Distance: Kuressaare to Leedri village ~ 33 km
- Driving time: ~30 min drive
- Website: [Flavour thrills in Saare County \(juniper syrup tastings\)](#) | [Visit Estonia](#)
- Contact: Liisi Kuivjõgi, Manager, kadkakoda@gmail.com
- Opening: 01. May to 31. August open daily (other times by appointment)
- Languages: info in Estonian, English
- Main services: farm architecture, stories and legends, syrup tastings
- Price: starting from 4€/per person
- Additional services: souvenir shop, workshops (maximum 10 people)



Muhu museum

- Distance: Kuressaare to Muhu museum ~ 67 km
- Driving time: ~50 min drive
- Website: [Muhu museum](#) | [Visit Estonia](#)
- Contact: Meelis Mereäär, Manager, meelis@muhumuuseum.ee
- Opening: 15. May to 15. September open daily (16. September to 14. May open Tuesday to Saturday)
- Languages: info in Estonian, English
- Main services: farm architecture, Muhu folk costumes, various exhibitions on Muhu history
- Price: ticket 7€, concession 5€
- Additional services: souvenir shop, guided tours



Kõpu and Tahkuna lighthouses

Kõpu lighthouse

- + Distance: Kärdla to Kõpu lighthouse 40 km
- + Driving time: 30 min drive
- + Website: <https://hiiumaa.ee/en/object/kopu-lighthouse/>
- + Contact: Ene Reidma, mummijaa@gmail.com
- + Opening: Year-round (May – September open daily)
- + Languages: EST, ENG
- + Main service: Lighthouse visit
- + Price: 5 €, concession 3 €, off-season ticket price for a group: 30€/h+ the single ticket price 5€/per person
- + Additional services: cafe, souvenir shop

Tahkuna lighthouse

- + Distance: Kärdla to Tahkuna lighthouse 18 km
- + Driving time: 17 min drive
- + Website: <https://hiiumaamuuseum.ee/en/tahkuna-lighthouse/>
- + Contact: Kauri Kiivrimees, kauri.kiivrimees@hiiumaamuuseum.ee
- + Opening: Year-round (May – September open daily)
- + Languages: EST, ENG
- + Main service: Lighthouse visit
- + Price: 4 €, concession 2 €, off-season opening fee: 30€/h
- + Additional services: cafe, souvenir shop



Hiiumaa museums

The long house museum

- + Distance: Heltermaa to Kärkla 25 km
- + Driving time: 20 min drive
- + Opening: Year-round
- + Main service: The museum presents islands history and everyday life
- + Price: 8 €, concession 7 €
- + Additional services: guided tours, workshops, souvenir shop, seminars

Rudolf Tobias home museum

- + Distance: Kärkla to Käina 21 km
- + Driving time: 19 min drive
- + Opening: Year-round (In summer open daily)
- + Main service: The House Museum of Rudolf Tobias, founder of Estonian classical music
- + Price: 7 €, concession 6 €; off-season opening fee: 30€
- + Additional services: guided tours, workshops

Kassari museum house

- + Distance: Kärkla to Kassari 27 km
- + Driving time: 23 min drive
- + Opening: Year-round (In summer open daily)
- + Main service: The museum presents culture and traditions of Hiiumaa
- + Additional services: guided tours, workshops, souvenir shop

Mihkli farm museum

- + Distance: Kärkla to Malvaste 10 km
- + Driving time: 8 min drive
- + Opening: Year-round (In summer open daily)
- + Main service: The museum presents rural life of Hiiumaa
- + Price: 8 €, concession 7 €; off-season opening fee: 30€
- + Additional services: guided tours, workshops, souvenir shop, catering

+ Languages: EST, ENG

+ Website: <https://hiiumaamuuseum.ee/en/>

+ Contact: Kauri Kiivrames, Director
kauri.kiivrames@hiiumaamuuseum.ee



Lavender Farm in paradisical Hiiumaa

- + Distance: Kärdla to Tubala 7 km
- + Driving time: 7 min drive
- + Website: [Lavender Farm in paradisical Hiiumaa](#)
- + Contact: Birthe Liivandi, lavendlitalu@gmail.com
- + Opening: July
- + Languages: Estonian, English
- + Main service: Visit of the northmost lavender field in the world
- + Additional services: Workshops, souvenir shop



Windtower experience centre

- + Distance: Kärla to Käina 21 km
- + Driving time: 19 min drive
- + Website: [Windtower Experience Centre](https://www.windtower.ee)
- + Contact: Krista Metsand, Manager, krista.metsand@hiiumaa.ee
- + Opening: Year-round
- + Languages: Estonian, English
- + Main service: Exhibition about Hiiumaa
- + Price: 12 €, concession 8€, group discount (from 10 persons) -10%
- + Additional services: Guided tours, indoor climbing wall, cafe, souvenir shop, bowling, swimming pool and sports centre, seminars



Suuremõisa castle

- + Distance: Heltermaa to Suuremõisa 6 km
- + Driving time: 6 min drive
- + Website: [Suuremõisa castle](#)
- + Contact: Ingrid Saarnak, the Manor House Administrator ingrid@hak.edu.ee
- + Opening: Year-round (In summer open daily)
- + Languages: Estonian, English
- + Main service: historical baroque manor visits
- + Price: 5 €, concession 4 €, Group (from 10 persons) 4 € per person
- + Additional services: guided tours, audioguide, souvenir shop (in summer), cafe, seminars



Picture by: Ivo Panasjuk

visit
estonia

Virumaa, East Estonia

Aqva Hotel & Spa

- + Location: Rakvere city
- + Website: AQVA hotel & spa
- + Contact: Sales: Tiina Andresson, tiina@aqvahotels.ee
- + Opening: Year-round
- + Size: 120 rooms
- + Main service: Accommodation, water park and sauna centre, spa treatments, 2 À la carte restaurants
- + Additional services: Fitness and sports facilities, conference and event services, services for children, beauty and wellness treatments



Rakvere Castle - Medieval adventure

- + Location: Rakvere city
- + Website: [Rakvere Castle](#)
- + Contact: sales: Helina Piho, +372 5333 8160
helina@svm.ee
- + Opening: The castle is open seasonally at different times. By prior booking, the castle is open year-round.
- + Languages: Electronic guide available in Estonian, Russian, English, Finnish, German, Latvian, and Lithuanian.
- + Main service: Medieval experience / theme park + museum
- + Duration: 1-2h
- + Price: 13 € per person, guide 60 € per group, availability of an e-guide
- + Additional services: Catering, workshops and activities, events and programmes, venue rental/event organisation, educational programmes



Vihula Manor Country Club & Spa

- + Distance: Rakvere – Vihula ~ 30km
- + Driving time: ~ 30min
- + Website: [Vihula manor](http://vihulamanor.com)
- + Contact: Marketing Project Manager – Dina Kivi,
marketing.vihula@uhotelsgroup.com
- + Opening: Year-round
- + Size: 80 rooms
- + Main service: Accommodation in a historic manor, spa and sauna centre, restaurant services
- + Additional services: onference and event services, wellness and beauty treatments, outdoor activities, cultural and historical experiences, services for private events

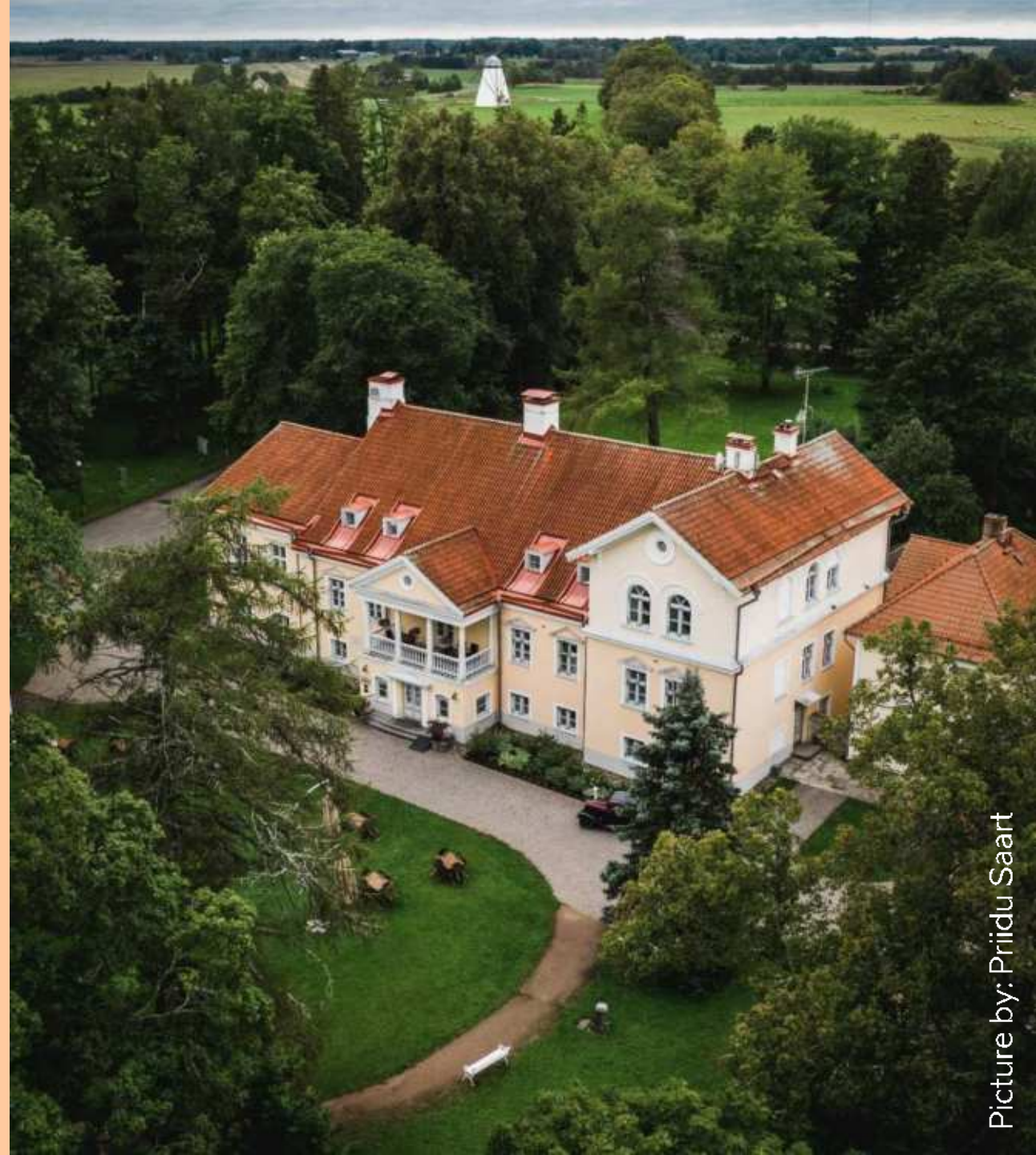

Altja Tavern

- + Distance: Rakvere — Altja ~35 km
- + Driving time: ~35—40 min drive
- + Website: [Altja Tavern](#)
- + Contact: info@altjaresto.ee
- + Opening: 24 April — 15 October, 12:00—20:00, and at other times by prior booking.
- + Group size: Number of seats indoors: 80, number of seats on the outdoor terrace (in summer): 60; They offer group menus for parties of at least 10 people and require a single, shared selection from all participants.
- + Main service: delicious traditional Estonian cuisine and an authentic tavern atmosphere
- + Price: Group menu from 24€ per person
- + Additional services: Nature of Lahemaa National Park, coastal area



Moe Distillery Museum and Visitor Center

- + Distance: Rakvere – Moe museum ~28 km
- + Driving time: ~25 min drive
- + Website: [Moe Distillery Museum and Visitor Center](https://www.moe.ee/en)
- + Contact: visit@moe.ee
- + Opening: An advanced bookings only
- + Group size: Guided tours are intended for groups of 10–30 people
- + Languages: Audio guide: EST, ENG, RUS, FIN
- + Main service: distillery museum experience
- + Duration: 1 – 1,5h
- + Price: From 10 € per person, guide 50 € per group
- + Additional services: tasting sessions, shop / souvenir sales, events and private functions, educational programs

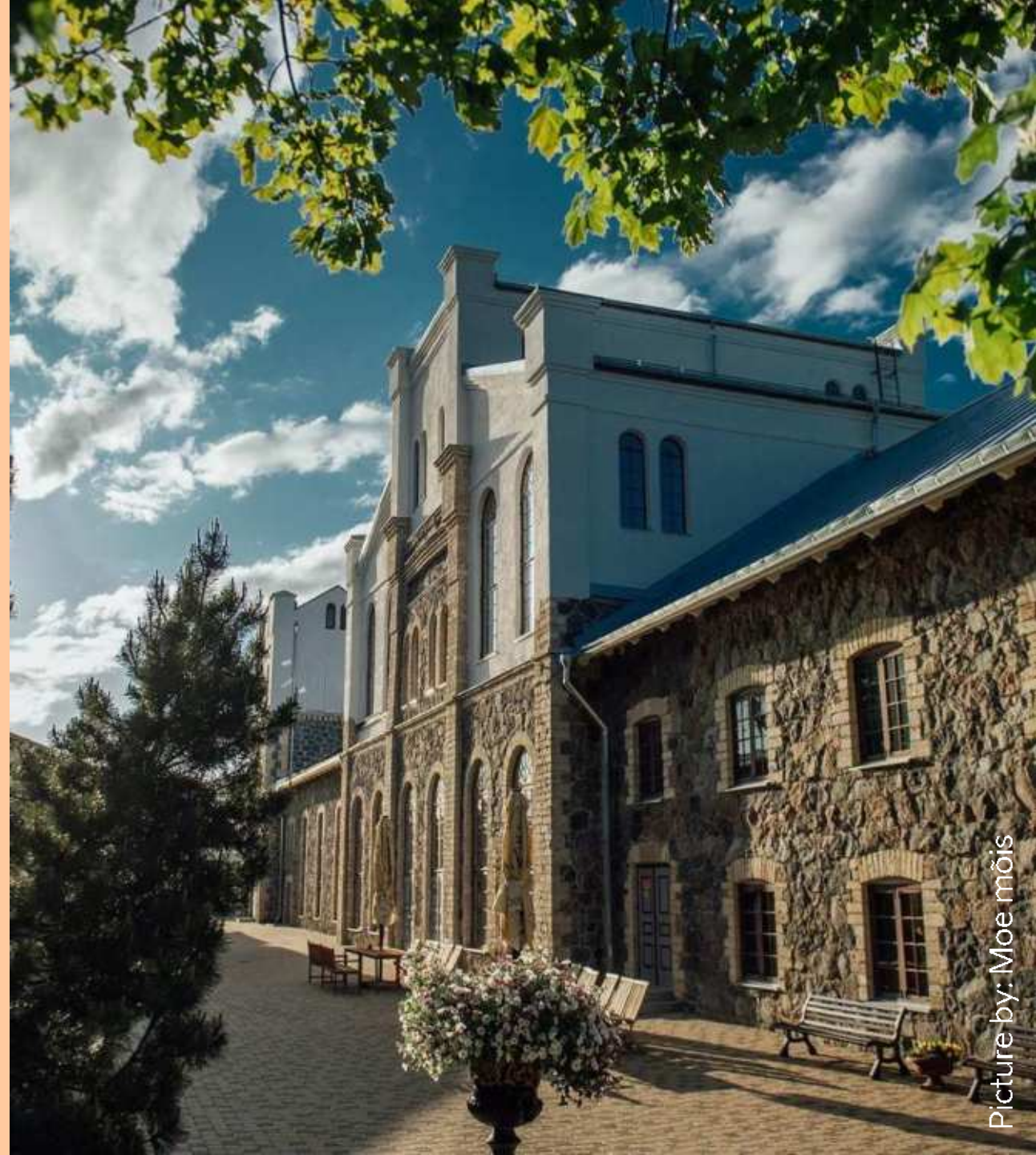

Estonian Mining Museum – deepest experience in Estonia

- + Distance: Kohtla-Järve – Estonian Mining Museum ~10 km
- + Driving time: ~13 min drive
- + Website: [Estonian Mining Museum](#) | [Visit Estonia](#)
- + Contact: etti.kagarov@kaevandusmuuseum.ee, tel: +372 5303 6799 (manager)
info@kaevandusmuuseum.ee; tel: +372 332 4017
- + Opening: Year-round
- + Group size: 35 people (in total it is possible to take 140 people underground, 35 people in the group with 15 min intervals)
- + Languages: English, Finnish, Estonian, Russian
- + Main service: The underground museum and the tour, where you can follow in the footsteps of real miners and get a sense of their daily working life in dark mining passages.
- + Duration: 1.5 hours
- + Price: €23 per person
- + Additional services: underground minors lunch; excursion with SUVs and motorboats to the former Aidu oil shale open-cast mine by Adrenaator Group.
- + Team events and conference centre up to 250 person



Virtual Reality Time Travelling Experience 'VR Toila 1938'

- + Distance: Toila — Oru park ~3 km
- + Driving time: ~5 min drive
- + Website: [Virtual tour 'VR Toila 1938' | Visit Estonia](#)
- + Contact: egle@blueray.ee; tel: +372 5343 9526
vrhistory@blueray.ee
- + Opening: for group bookings year-round; main season June-August WED-SUN 11AM-6PM
- + Group size: up to 75 people
- + Languages: Estonian, English, Finnish, German, Latvian, Lithuanian, Russian
- + Main service: An adventurous time travel through the virtual reality to the Presidential Palace and Park of Toila-Valley in July 1938. 3 different parts, 3 different adventures and experiences.
- + Duration: 40 min/one part
- + Price: groups from 10 people €13 per one part



Narva Museum

- + Location: Narva city
- + Website: Narva Museum
- + Contact: info@narvamuseum.ee; tel: +372 359 9230
- + Opening: Year-round
- + Group size: 30 people (if the group size exceeds 30 people, the group is divided into several groups)
- + Languages: English, Ukrainian, Estonian, Russian
- + Main service: Tour of the castle "The History of Narva Castle"
- + Duration: 1.5 hours
- + Price: 16 € per person, guide 50 € per group
- + Additional services: the art gallery tour; Guided tour of the 'Model of Old Narva' exhibition; guided tour of the 'Icon Room' exhibition; city sightseeing tour "The history of Narva"; excursion "Krenholm: the history of the textile giant,"; excursion "Joala factory: from the basement to the tower,"; excursion in Narva-Jõesuu — The Story of a Retro Resort and Escape from the City Hustle; excursion "Swedish Narva,"; "Narva Gardens and Parks," tour



Mysterious Sillamäe town – museum, tour and promenades

- + Distance: Narva – Sillamäe ~32 km
- + Driving time: ~30 min drive
- + Website: [Sillamäe Mere puiestee \(Sea Boulevard\) and promenade | Visit Estonia](#)
- + Contact: info@sillamae-muuseum.ee; tel: +372 3972425
- + Opening: Year-round
- + Group size: up to 50 people city tour / in museum max 30 people
- + Languages: English, Estonian, Russian
- + Main service: city tour Mysterious Sillamäe
- + Duration: 1.5 hours
- + Price: €75 per city tour
- + Additional services: Sillamäe museum, virtual reality

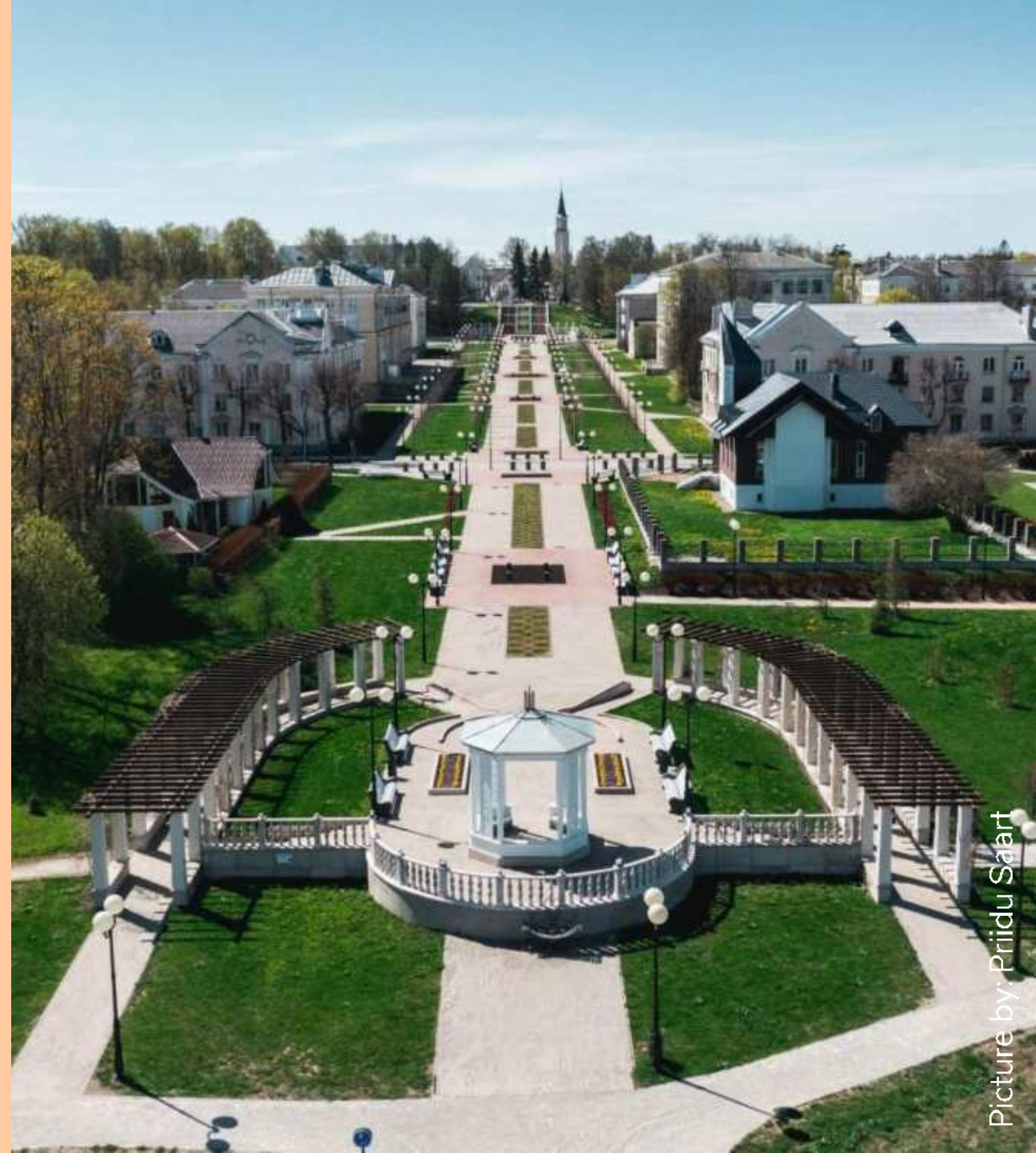

Saka Manor

- + Distance: Kohtla-Järve — Saka Manor ~11 km
- + Driving time: ~12 min drive
- + Website: [Saka manor | Visit Estonia](#)
- + Contact: salle@saka.ee; tel: +372 5646 6973
saka@saka.ee; +372 3364 900
- + Opening: Year-round
- + Size: in total 41 rooms (main hotel building + mansion)
- + Main service: accommodation; wellness spa with pools, saunas and treatments, restaurant Cliff. Saka Manor is one of the few Estonian manor complexes that has been restored in its entirety.
- + Additional services/opportunities: private events, corporate events, tennis courts, hiking trail on spot, Estonian 2nd highest waterfall (Kivisilla) on spot



visit
estonia

Find out more:
visitestonia.com
official tourist information